

Resolution #18-18

**RESOLUTION OF THE PLANNING COMMISSION OF THE TOWN OF GREENVILLE
APPROVING A SITE PLAN FOR ARFF LOCATED AT PARCEL# 110123100, 110123500,
110123600 & 110123702**

WHEREAS, a site plan request has been applied for ARFF Live Burn Site located at Parcel #s 110123100, 110123500, 110123600 & 110123702 as shown on Exhibit A; and

WHEREAS, the approval shall be conditioned on the following

1. No construction permits shall be issued until all plans, as shown on Exhibit A, meet local, county, state and federal ordinance and statutory requirements; and

NOW, THEREFORE, BE IT RESOLVED that the Planning Commission of the Town of Greenville hereby approves the site plan for ATW Live Burn Site.

This resolution was adopted by the Town of Greenville Planning Commission on the 25th day of June, 2018:

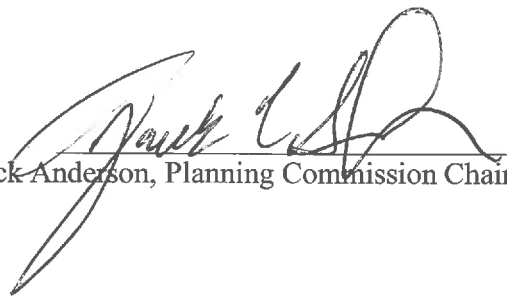

Jack Anderson, Planning Commission Chairperson

ATTEST:



Wendy Helgeson, Town Clerk

Motion to Approve Resolution No. #18-18 made by

Votes:

Title	Name	Aye	Nay	Other
Chairperson	Anderson	X		
Commissioner	Cotter	X		
Commissioner	Ecker	X		
Commissioner	Kippenhan	X		
Commissioner	Meidam-Wincentsen	X		
Commissioner	Strobel	X		
Commissioner	Zilisch	Excused		

Posted: 6/28/18

1101

DATE

PROJECT NO.

PROJECT NAME

DATE

PROJECT NO.

PROJECT NAME

DATE

PROJECT NO.

PROJECT NAME

DATE

PROJECT NO.

PROJECT NAME

DATE

PROJECT NO.

PROJECT NAME

DATE

PROJECT NO.

PROJECT NAME

DATE

PROJECT NO.

PROJECT NAME

DATE

PROJECT NO.

PROJECT NAME

DATE

PROJECT NO.

PROJECT NAME

DATE

PROJECT NO.

PROJECT NAME

DATE

PROJECT NO.

PROJECT NAME

DATE

PROJECT NO.

PROJECT NAME

DATE

PROJECT NO.

PROJECT NAME

DATE

PROJECT NO.

PROJECT NAME

DATE

PROJECT NO.

PROJECT NAME

DATE

PROJECT NO.

PROJECT NAME

DATE

PROJECT NO.

PROJECT NAME

DATE

PROJECT NO.

PROJECT NAME

DATE

PROJECT NO.

PROJECT NAME

DATE

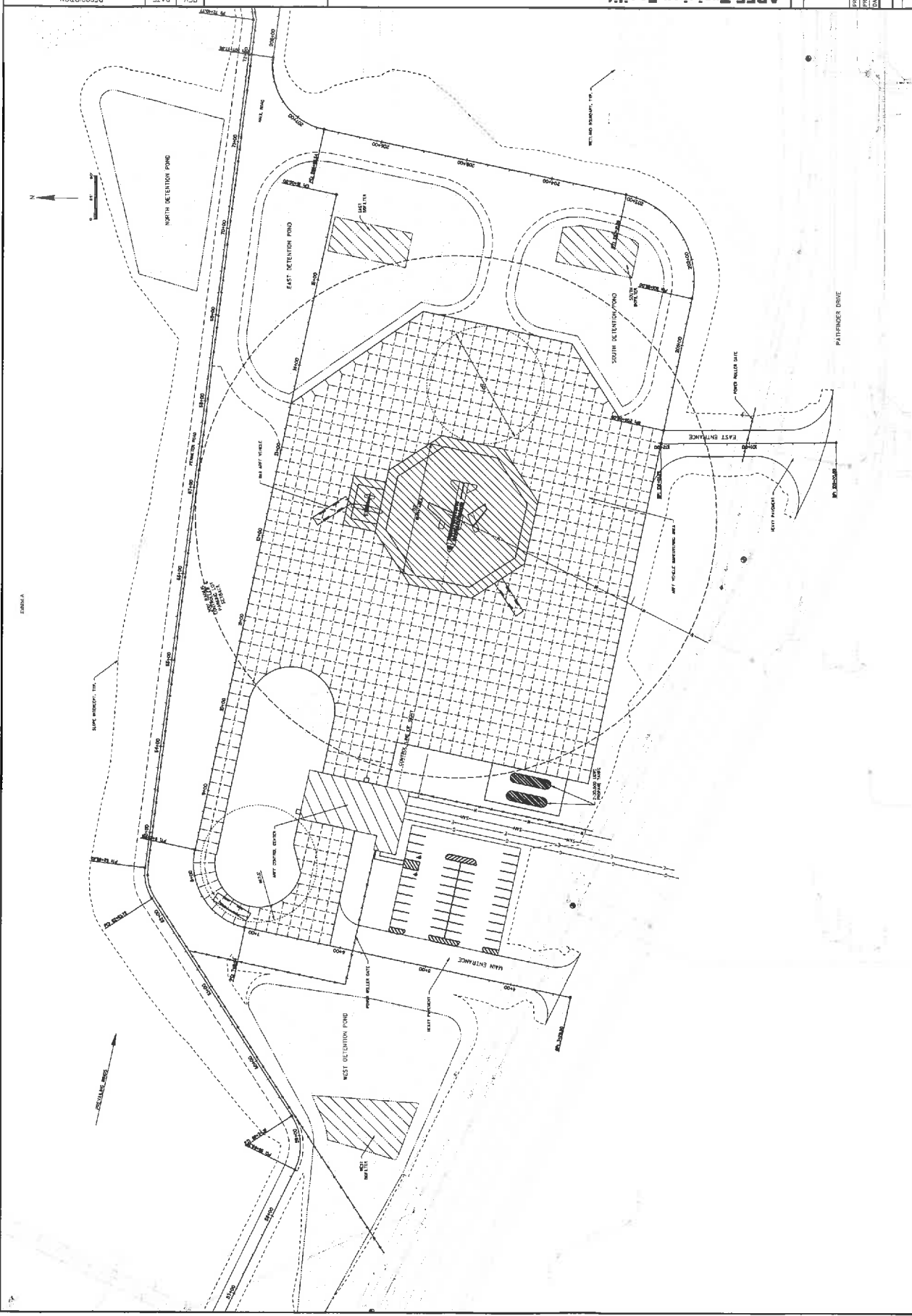

REV.	DATE	DESCRIPTION

ARFF Training Facility
Appleton International Airport
Pathfinder Drive
Appleton
WI

© 2012 Omni Associates, Inc. - This design, drawing and detail is the copyrighted property of Omni Associates, Inc. No part may be copied, duplicated, distributed or reproduced in any manner without written consent of Omni Associates, Inc.